

# LEVETTE SERIE 2

CAM SERIES 2 • ZUNGE SERIE 2 • CAMES SERIE 2

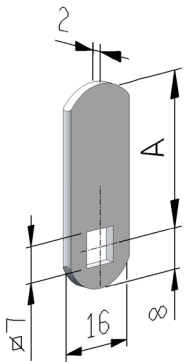

SERIE 2A	
A (mm)	PART #
16	259ZB
20	260ZB
21,5	258ZB
24,5	270ZB
32	269ZB
48	157ZB
66,5	291ZB

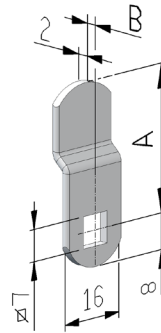

SERIE 2AP		
A (mm)	B (mm)	PART #
48	2	157ZBPG01
66	2	291ZBPG01
19,5	3	260ZBPG
31,5	3	269ZBPG01
47	4	157ZBPG03
45,5	6	157ZBPG04
45	7	157ZBPG02

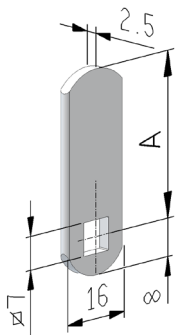

SERIE 2B	
A (mm)	PART #
16	199ZB
17,5	202ZB
22	287ZB
23,5	152ZB
24,5	227ZB
28	151ZB
30	244ZB
32	228ZB
35	130ZB
37,5	229ZB
42	241ZB
46	230ZB
52,5	231ZB
62	292ZB
66,5	232ZB
83	126ZB

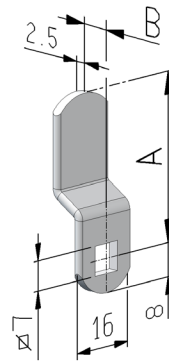

SERIE 2BP		
A (mm)	B (mm)	PART #
24,5	2	227ZBPG01
27,8	2	151ZBPG01
34,5	2	130ZBPG07
31,5	3	228ZBPG04
41,5	3	241ZBPG06
41	4	241ZBPG01
65,5	4	232ZBPG01
30	5	228ZBPG02
33	5	130ZBPG05
35,5	5	229ZBPG02
60,5	5	292ZBPG03
29	6,6	228ZBPG05
28	7	228ZBPG03
42	7	230ZBPG05
37	7,3	136ZBPG
32,5	8	229ZBPG01
29,5	8,7	130ZBPG02
30,5	9,5	130ZBPG01
38	9,5	241ZBPG03
35,5	10	241ZBPG02
40	10	230ZBPG07
46,5	10	231ZBPG01
26,5	12	228ZBPG01
35,5	15	230ZBPG

SERIE 2C	
A (mm)	PART #
19,8	143
32	131
46	132

**ACCIAIO INOX**  
STAINLESS STEEL - EDELSTHAL - ACIER INOX

SERIE 2CP		
A (mm)	B (mm)	PART #
45	3	132PG01

**ACCIAIO INOX**  
STAINLESS STEEL - EDELSTHAL - ACIER INOX

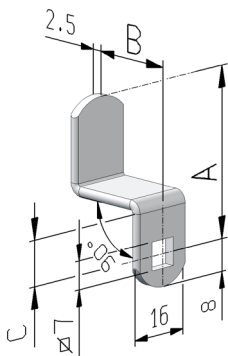

SERIE 2DP			
A (mm)	B (mm)	C (mm)	PART #
36,5	12,5	10	230ZBPG06
23	14,5	7,5	130ZBPG06
34,5	20,5	11	231ZBPG03
30,5	24,5	9,5	231ZBPG02
22	25,5	9	230ZBPG01
37,5	32	13,5	232ZBPG02

# LEVETTE SERIE 2

CAM SERIES 2 • ZUNGE SERIE 2 • CAMES SERIE 2

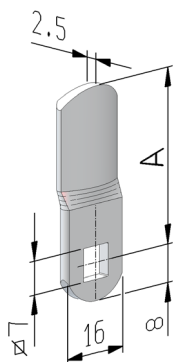

SERIE 2E	
A (mm)	PART #
22	287ZBBM01
32	228ZBBM01
37,5	229ZBBM01
42	241ZBBM01
46	230ZBBM01
52,5	231ZBBM01
62	292ZBBM01

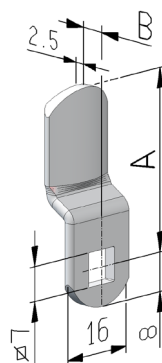

SERIE 2EP		
A (mm)	B (mm)	PART #
35,5	5	229ZBPG02BM
35,5	10	241ZBPG07BM

SEZIONE A4

**ACCESSORIO PER CHIUSURA A 3 PUNTI IN ZAMA ZINCATA: PART # 2063ZBRBS**  
 3-POINT CAM ACCESSORY IN GALVANIZED ZINC ALLOY • 3-PUNKT-ZUNGE AUS VERZINKTER ZINKLEGIERUNG  
 ACCESSOIRE POUR FERMETURE A 3 POINTS EN ZAMAK ZINGUE

A (mm)	PART #
2B - 2BP - 2C - 2CP - 2DP - 2E - 2EP	2063ZBRBS
SEEGER	

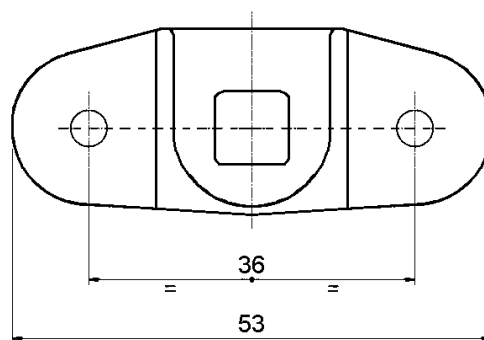
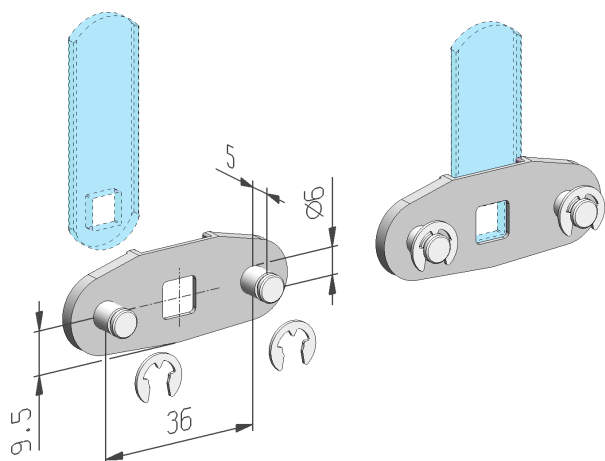

# LEVETTE SPECIALI SERIE 2

SPECIAL CAMS SERIES 2 • SPEZIELLE ZUNGEN SERIE 2 • CAMES SPECIALES SERIE 2

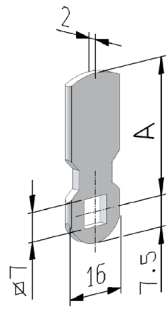

A (mm)	PART #
29,5	211ZB
33	163ZB

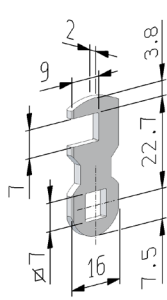

PART #
153ZB



A (mm)	PART #
20,5	154ZBRC

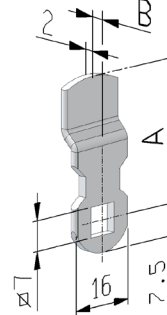

A (mm)	B (mm)	PART #
28,5	3	211ZBPG04
28,5	3	211ZBPG01
27,5	5	211ZBPG05
33	6	313ZBPG

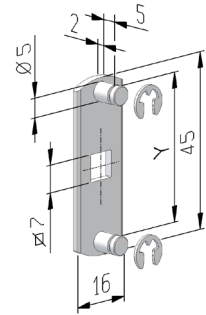

Y (mm)	PART #
30	179NIRB01S
38	178NIRBS
SEEGER	

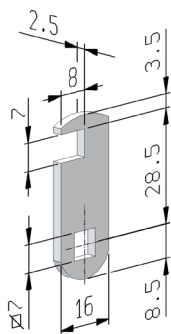

PART #
236ZB

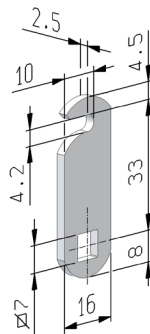

PART #
229ZBRC01

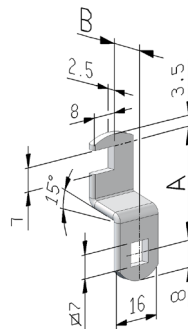

A (mm)	B (mm)	PART #
29,5	5	237ZBPG
29,5	10	238ZBPG
29,5	15	239ZBPG

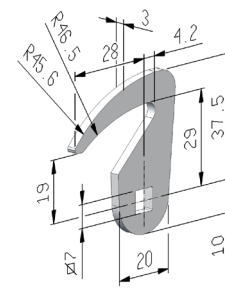

PART #
194ZB

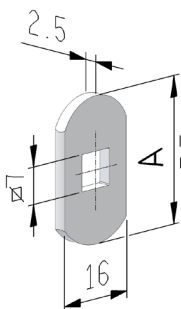

A (mm)	PART #
28	144ZB
36	148ZB

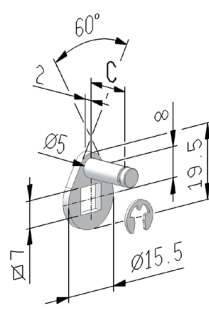

C (mm)	PART #
11,7	203NIRB01S
14,7	203NIRB02S
SEEGER	

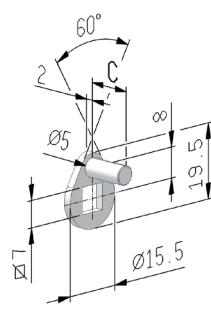

C (mm)	PART #
19	203NIRB03
60	203NIRB04

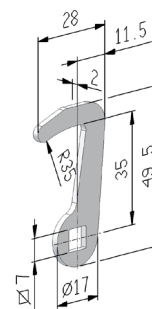

PART #
274NI

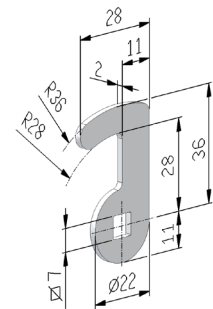

PART #
271NI