



# Oval Sight Glass

## Rounded Ends

For welding

**Type**  
**337**

### Application:

For visual observation of fluid levels in vessels, boilers and silos.

**Operating pressure:**  
Up to 25 bar

### Operating conditions:

Temperature:	70	°C
(Depending on glass)	100	°C
	243	°C
Pressure:	25	Bar

### Materials:

Flange:	S235JRG2 1.4571
Glass:	PMMA protrusion Soda Lime glass DIN 8903 Borosilicate glass DIN 7081
Seal:	PTFE (200°C) FKM (200°C) NBR (100°C) C4400 (150°C) Silicone (200°C) EPDM (140°C) Graphite (280°C)

Other materials on request

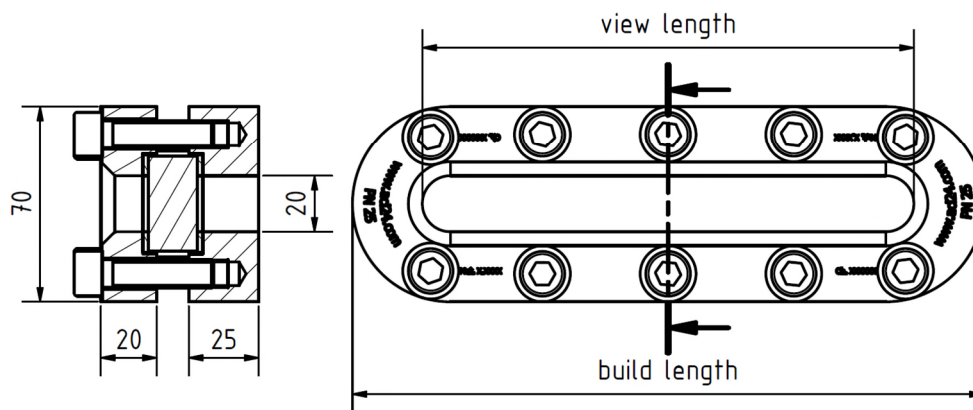
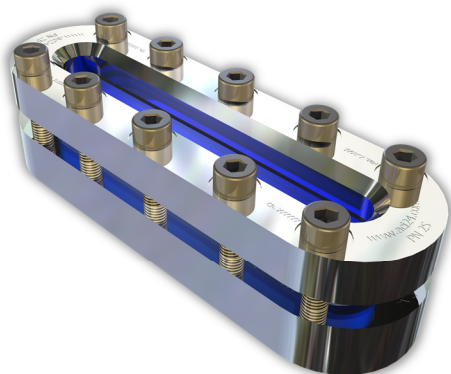

<b>Build length</b>	<b>176</b>	<b>226</b>	<b>256</b>	<b>316</b>	<b>376</b>	<b>436</b>	<b>496</b>	<b>536</b>
View length	126	176	206	266	326	386	446	486
Kg	3.3	4.2	4.8	5.9	7.0	8.1	9.2	10.0

### Installation guideline:

After welding the base flange onto/into the pressure vessel, the sealing surface must be checked for deformations! Reworking may be required!

The operating pressure does not relate to the base flange! The base flange must be audited according to AD 2000 guidelines together with the pressure vessel!

Technical changes and errors reserved!

ACI Industriearmaturen GmbH  
www.aci24.com • info@aci24.com  
Version 2017-07-14



# Oval Sight Glass

## Rounded Ends

For welding

# Type 337

Product code:

		Inst. length	Flange	Glass	Seal	Variants
11	337	Acc. To table	1: St. S235JRG 2: VA 1.4571 3: 1.4404 4: 1.4301 5: Base flange VA, Cover flange St. 6: Base flange St., Cover flange VA 7: Duplex	1: BS Transparent 2: SL Transparent 3: BS Reflex 4: SL Reflex 5: PMMA Stufenglas	1: PTFE 2: FKM 3: NBR 4: C4400 5: Silicone 6: EPDM 7: Graphite 8: Special	Assigned by ACI as required

Example: **ACI Type 337**  
226 mm  
Flange 1.4571  
Borosilicate transparent  
Seal PTFE  
Standard construction

11-337-226-2-1-1-000

## Recommendation:

For corrosive media or steam, we recommend adding a mica disk to protect the glass!