

IMPULSE WRENCHES

CORDLESS SHUT-OFF IMPULSE WRENCHES

High tightening speed combined with high accuracy. No reaction forces during the tightening process. No tightening functionality when battery charge is low, thus process safety improves. Very well suited in areas where cables and hoses impede handling flexibility of tools, such as interiors of cars, coaches and trains.

Characteristics:

- Brushless motor
- 18 Volt Lithium-Ion battery (choice for 2,0 Ah or 4,0 Ah capacity)
- LED status indicates: Reverse, OK, NOK, Battery low
- Torque adjustable
- Fine-tuning on hardness of the joint, electronically
- Non-contact trigger with 2 steps
- Run-down speed up to 4500 RPM
- Battery and charger to be ordered separately



Type	Square/Hex drive	Torque Nm	RPM	Weight kg
RRI-BIM15AT	1/4" Hex	7 - 15	4.500	1,16
RRI-BIM15T	3/8" Square	8 - 15	4.500	1,16
RRI-BIM25AT	1/4" hex	14 - 23	4.500	1,18
RRI-BIM25T	3/8" Square	15 - 25	4.500	1,18
RRI-BIM35T	3/8" Square	22 - 35	3.500	1,36
RRI-BIM45T	3/8" Square	32 - 45	3.500	1,42

Charger and Li-Ion battery



Charger

Battery

Battery 2 Ah, 0,36 kg
Battery 4 Ah, 0,64 kg
Charger 18 Volt

Cycles per battery charge, hard joint
2 Ah: 300 - 350 cycles
4 Ah: 700 - 750 cycles
Depending on time and torque

Type	Order number
Charger (40 Min.)	B84192B
Li-Ion Battery 18V 2 Ah	BB180C-320
Li-Ion-Battery 18V 4 Ah	BB180C-340
Power cord	E86B-VD European style E86B-UK style

Characteristics



Programmer

A programmer, suitable for all types of RRI-BIM impulse wrenches (and RRI-BS screwdrivers). For details, see page 20.



Type	Order number
Programmer	B745C180B

LED-indicator OK/NOK

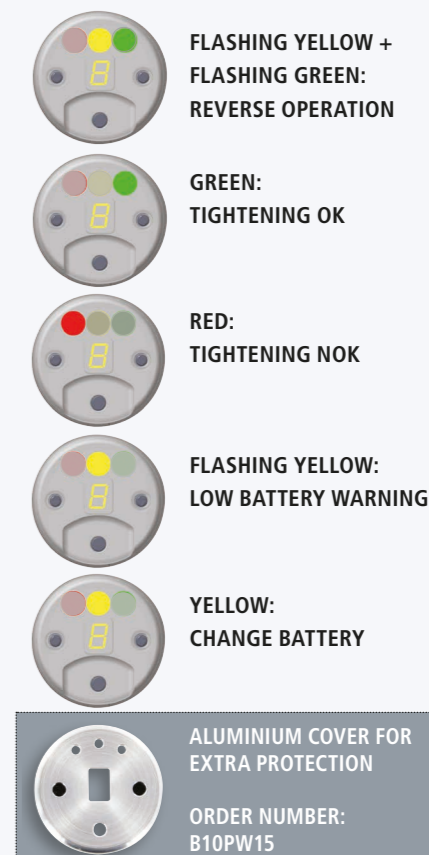
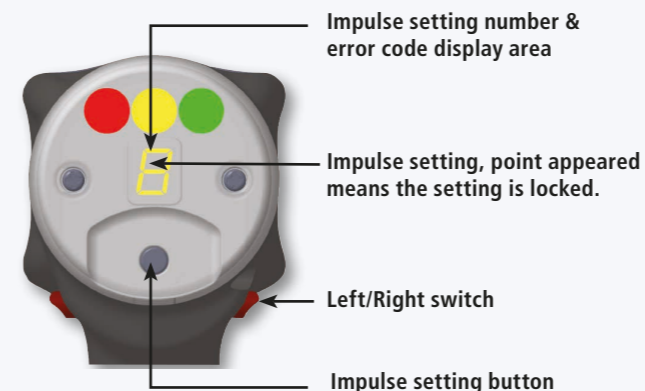

Blocking adjustment of the shut-off:

- Remove battery
 - Mount battery and simultaneously push trigger and L/R Switch until sound signal (5 seconds), then release trigger and L/R Switch.
- Deblocking = same

Blocking Un-tightening

- Remove battery
 - Mount battery and simultaneously push L/R Switch until sound signal (5 seconds)
- Deblocking = same

Mechanical shut-off or electronic controlled shut-off impulse wrenches

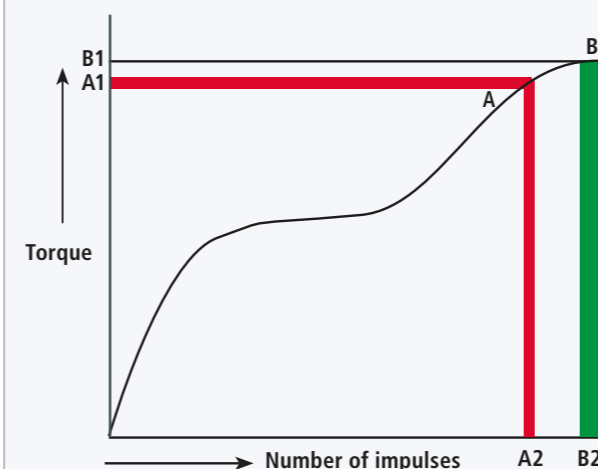

A = shut-off area of mechanical shut-off impulse wrenches
B = shut-off area of electronic controlled shut-off impulse wrenches. Optimum tension with lower relaxation.

Joint Quality

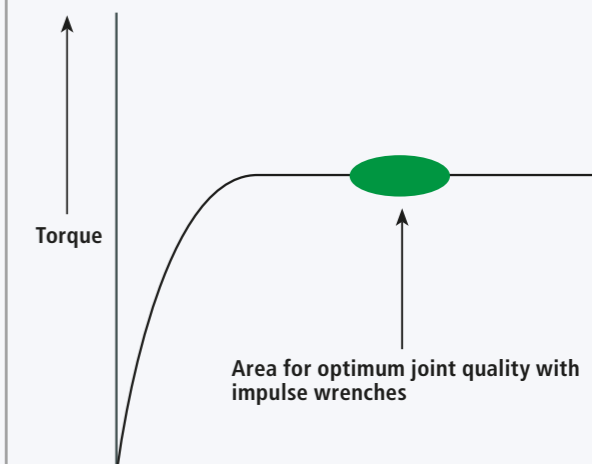

For hard joints:
Numerical setting: (2-3-4)

For soft joints:
Numerical setting: (6-7-8-9)

For middle soft joints:
Numerical setting: (4-5-6)