

Flat pot magnets of hard ferrite

Flat pot magnets of hard ferrite, with internal thread, galvanized

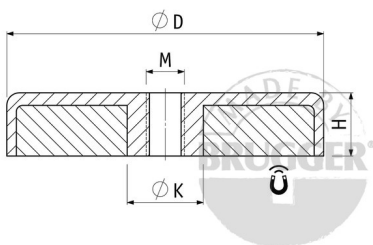
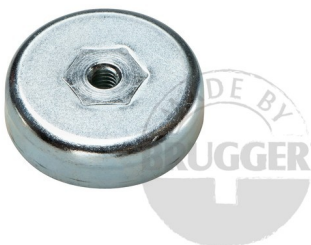

Article number	D mm	H mm	K mm	Thread M	Force* N	Weight g	Temperature °C
F25D-vM4	25 <sup>+0.1</sup> / <sub>-0.1</sub>	7 <sup>+0.3</sup> / <sub>-0.2</sub>	5.2	M4	36	18	200
F32D-vM4	32 <sup>+0.1</sup> / <sub>-0.1</sub>	7 <sup>+0.3</sup> / <sub>-0.2</sub>	5.2	M4	75	29	200
F40D-vM4	40 <sup>+0.2</sup> / <sub>-0.1</sub>	8 <sup>+0.4</sup> / <sub>-0.2</sub>	5.2	M4	90	53	200
F50D-vM6	50 <sup>+0.2</sup> / <sub>-0.1</sub>	10 <sup>+0.5</sup> / <sub>-0.2</sub>	12	M6	170	94	200
F50D-vM8	50 <sup>+0.2</sup> / <sub>-0.1</sub>	10 <sup>+0.5</sup> / <sub>-0.2</sub>	12	M8	170	94	200
F63D-vM8	63 <sup>+0.3</sup> / <sub>-0.1</sub>	14 <sup>+0.5</sup> / <sub>-0.2</sub>	13	M8	290	206	200
F80D-vM8	80 <sup>+0.3</sup> / <sub>-0.1</sub>	18 <sup>+0.5</sup> / <sub>-0.2</sub>	14.5	M8	550	472	200
FG080HFD-08v-00 <sup>1</sup>	80 <sup>+0.3</sup> / <sub>-0.1</sub>	10 <sup>+0.5</sup> / <sub>-0.2</sub>	12	M8	550	240	200
F80D-vM10	80 <sup>+0.3</sup> / <sub>-0.1</sub>	18 <sup>+0.5</sup> / <sub>-0.2</sub>	14.5	M10	550	466	200

<sup>1</sup> Housing punched from strip steel, rear chamfer with radius

Alternative to the standard we also offer individual solutions:

» Corrosion protection with black galvanised housing surfaces (up to 720 hours in a salt spray test - depending on the magnet material)



\* The forces have been determined at room temperature on a plate in polished steel (S235JR according to DIN 10 025) with a thickness of 10 mm (1kg ~ 10N). A maximum deviation of -10% compared to the specified value is possible in exceptional cases. Value is exceeded in general. Depending on the type of application (installation situation, temperatures, counter anchor etc.) the forces can be influenced enormously. The indicated values are serving as an orientation. Please get advice and help from our experts.