

Flat pot magnets of hard ferrite

Flat pot magnets of hard ferrite, with screwed bush, stainless steel body

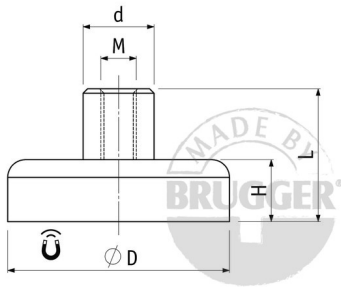

| Article number | D mm | d mm | H mm | L mm | Thread M | Force* N | Weight g | Temperature °C |
|----------------|--------------------------------------|-------------------------------------|--------------------------------------|--|----------|----------|----------|----------------|
| F25A-4016M5 | 25 ^{+0.1} / _{-0.1} | 8 ^{+0.2} / _{-0.2} | 7 ^{+0.3} / _{-0.2} | 16 ^{+0.5} / _{-0.3} | M5 | 32 | 20 | 220 |
| F32A-4016M5 | 32 ^{+0.1} / _{-0.1} | 8 ^{+0.2} / _{-0.2} | 7 ^{+0.3} / _{-0.2} | 16 ^{+0.5} / _{-0.3} | M5 | 64 | 31 | 220 |
| F40A-4016M5 | 40 ^{+0.2} / _{-0.1} | 8 ^{+0.2} / _{-0.2} | 8 ^{+0.3} / _{-0.2} | 16.5 ^{+0.5} / _{-0.3} | M5 | 100 | 56 | 220 |
| F50A-4016M5 | 50 ^{+0.2} / _{-0.1} | 8 ^{+0.2} / _{-0.2} | 10 ^{+0.4} / _{-0.2} | 18.5 ^{+0.6} / _{-0.3} | M5 | 175 | 105 | 220 |
| F63A-4016M5 | 63 ^{+0.3} / _{-0.1} | 8 ^{+0.2} / _{-0.2} | 14 ^{+0.5} / _{-0.2} | 22 ^{+0.7} / _{-0.3} | M5 | 280 | 228 | 220 |

PRODUCT INFORMATION:

The systems offer better resistance to chemicals than normal steel galvanised flat pot magnets. The systems offer higher temperature resistance to chemicals than normal steel galvanised flat pot magnets.



* The forces have been determined at room temperature on a plate in polished steel (S235JR according to DIN 10 025) with a thickness of 10 mm (1kg ~ 10N). A maximum deviation of -10% compared to the specified value is possible in exceptional cases. Value is exceeded in general. Depending on the type of application (installation situation, temperatures, counter anchor etc.) the forces can be influenced enormously. The indicated values are serving as an orientation. Please get advice and help from our experts.